

# MV-CH160-60GM

## 16 MP 1.1" CMOS GigE Area Scan Camera



GEN<i>i</i>CAM

GIGE  
VISION

### Introduction

MV-CH160-60GM camera adopts CMOS sensor to provide high-quality images. It uses GigE interface to transmit non-compressed images in real time, and its max. frame rate can reach 7.25 fps in full resolution.

### Key Feature

- Resolution of 4000 × 4000, pixel size of 3.2 μm × 3.2 μm.
- Adopts GigE interface and max. transmission distance of 100 meters without relay.
- Supports hardware trigger, software trigger, and free run.
- Compatible with GigE Vision V2.0 Protocol, GenICam Standard, and third-party software based on the protocol and standard.

### Dimension

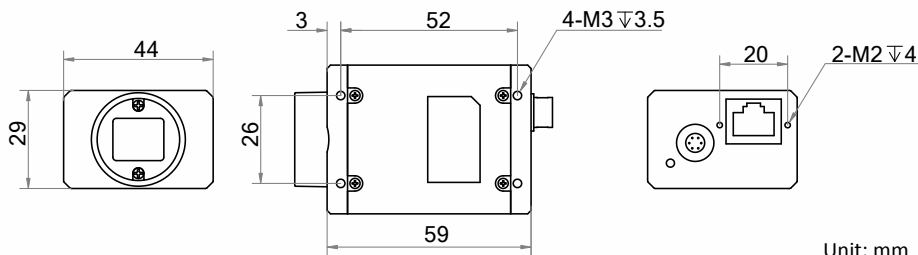

### Available Model

MV-CH160-60GM

### Applicable Industry

Lithium battery, SMT/ PCB AOI, FPD, railway related applications, etc.

### Sensor Quantum Efficiency

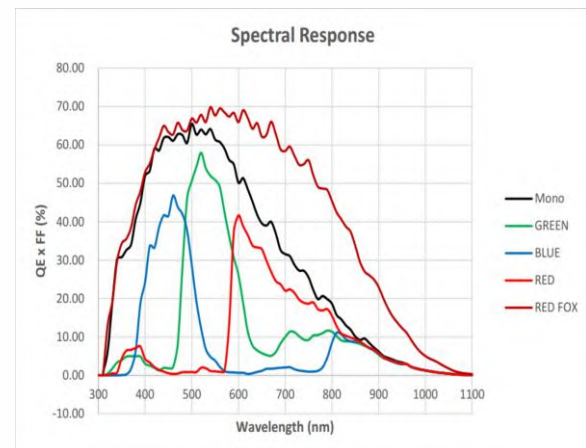

## Specification

<b>Model</b>	<b>MV-CH160-60GM</b>
<b>Camera</b>	
<b>Sensor type</b>	CMOS, global shutter
<b>Sensor model</b>	HK
<b>Pixel size</b>	3.2 $\mu\text{m}$ $\times$ 3.2 $\mu\text{m}$
<b>Sensor size</b>	1.1"
<b>Resolution</b>	4000 $\times$ 4000
<b>Max. frame rate</b>	7.25 fps @4000 $\times$ 4000 Mono 8
<b>Dynamic range</b>	65 dB
<b>SNR</b>	38 dB
<b>Gain</b>	6 dB to 14 dB
<b>Exposure time</b>	12 $\mu\text{s}$ to 10 sec
<b>Exposure mode</b>	Off/Once/Continuous exposure mode
<b>Mono/color</b>	Mono
<b>Pixel format</b>	Mono 8/10/12
<b>Binning</b>	Supports 1 $\times$ 1, 2 $\times$ 2, 4 $\times$ 4
<b>Decimation</b>	Supports 1 $\times$ 1, 2 $\times$ 2, 4 $\times$ 4
<b>Reverse image</b>	Supports horizontal and vertical reverse image output
<b>Electrical feature</b>	
<b>Data interface</b>	Gigabit Ethernet, compatible with Fast Ethernet
<b>Digital I/O</b>	6-pin P7 connector provides power and I/O, including opto-isolated input $\times$ 1 (Line 0), opto-isolated output $\times$ 1 (Line 1), bi-directional non-isolated I/O $\times$ 1 (Line 2).
<b>Power supply</b>	9 VDC to 26 VDC, supports PoE
<b>Power consumption</b>	Typ. 3.72 W@12 VDC
<b>Mechanical</b>	
<b>Lens mount</b>	C-mount
<b>Dimension</b>	29 mm $\times$ 44 mm $\times$ 59 mm (1.1" $\times$ 1.7" $\times$ 2.3")
<b>Weight</b>	Approx. 100 g (0.2 lb.)
<b>Ingress protection</b>	IP30 (under proper lens installation and wiring)
<b>Temperature</b>	Working temperature: 0 $^{\circ}\text{C}$ to 50 $^{\circ}\text{C}$ (32 $^{\circ}\text{F}$ to 122 $^{\circ}\text{F}$ ) Storage temperature: -30 $^{\circ}\text{C}$ to 70 $^{\circ}\text{C}$ (-22 $^{\circ}\text{F}$ to 158 $^{\circ}\text{F}$ )
<b>Humidity</b>	20% to 80% RH, non-condensing
<b>General</b>	
<b>Client software</b>	MVS or third-party software meeting with GigE Vision Protocol
<b>Operating system</b>	32/64-bit Windows XP/7/10, 32/64-bit Linux and 64-bit MacOS
<b>Compatibility</b>	GigE Vision V2.0, GenICam
<b>Certification</b>	CE, RoHS, KC

**HIKROBOT**

Hangzhou Hikrobot Co., Ltd.  
en.hikrobotics.com

© Hangzhou Hikrobot Co., Ltd. All Rights Reserved.  
Hangzhou Hikrobot does not tolerate any infringement. Any organization or individual may not imitate or reproduce in whole or in part of the content. The data herein is based on Hikrobot's internal evaluation. Actual data may vary depending on specific configuration and operating condition. The information herein is subject to change without notice. All the content has been checked conscientiously. Nevertheless, Hikrobot shall not be liable to damages resulting from errors, inconsistencies or omissions.