

MV-CE200-10UM/UC

20 MP 1" CMOS USB3.0 Area Scan Camera

Introduction

MV-CE200-10UM/UC camera adopts Sony IMX183 sensor to provide high-quality image. It uses USB3.0 interface to transmit non-compressed images in real time with max. frame rate reaching 14 fps.



GEN<i>i>CAM

USB3 VISION™

Key Feature

- Supports gain adjustment, exposure time, white balance, LUT, Gamma correction and binning
- Supports hardware triggering, software triggering and free run mode
- Adopts M2 screw holes for securing cable that connects USB3.0 interface
- Compatible with USB3 Vision Protocol, GenlCam Standard, and the third-party software based on these and standard

Available Model

- Mono Camera: MV-CE200-10UM
- Color Camera: MV-CE200-10UC

Applicable Industry

Electronic semiconductor, factory automation, medical packaging, etc.

Sensor Quantum Efficiency

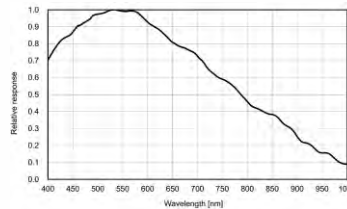

MV-CE200-10UM

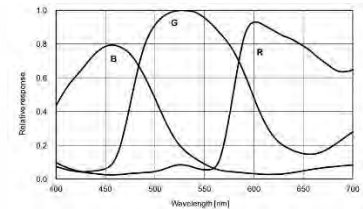

MV-CE200-10UC

Dimension

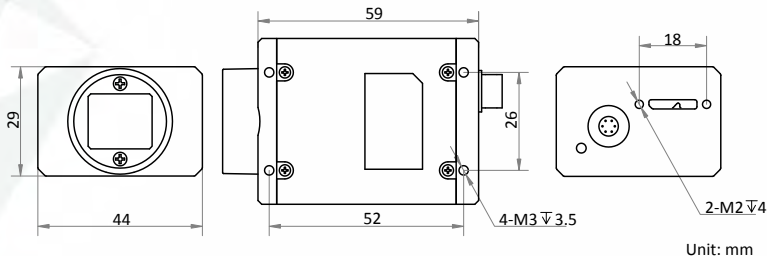

Specification

Model	MV-CE200-10UM	MV-CE200-10UC
Camera		
Sensor type	CMOS, rolling shutter	
Sensor model	Sony IMX183	
Pixel size	2.4 μm × 2.4 μm	
Sensor size	1"	
Resolution	5472 × 3648	
Frame rate	14 fps	
Dynamic range	65.5 dB	
SNR	41.5 dB	
Gain	0 dB to 20 dB	
Exposure time	19 μs to 1 s	44 μs to 1 s
Shutter mode	Off/Once/Continuous exposure mode	
Mono/color	Mono	Color
Pixel format	Mono 8/10/10p/12/12p	Mono 8/10/12, Bayer GB 8/10/10p/12/12p, YUV422Packed, YUV422_YUYV_Packed, RGB8
Binning	Supports 1 × 2, 2 × 1, 1 × 4, 4 × 1, 2 × 2, 2 × 4, 4 × 2, 4 × 4	
Decimation	Supports 1 × 2, 2 × 1, 1 × 4, 4 × 1, 2 × 2, 2 × 4, 4 × 2, 4 × 4	
Reverse image	Supports horizontal reverse image output	
Image buffer	128 MB	
Electrical features		
Data interface	USB3.0	
Digital I/O	6-pin Hirose connector provides power and I/O, including opto-isolated input x 1 (Line0), opto-isolated output x 1 (Line1), bi-directional non-isolated I/O x 1 (Line2)	
Power supply	5 VDC to 15 VDC, supports USB3.0 power supply	
Power consumption	Approx. 2.83 W@5 VDC	
Structure		
Lens mount	C-Mount	
Dimension	44 mm × 29 mm × 59 mm (1.7" × 1.1" × 2.3")	
Weight	Approx. 100 g (0.2 lb.)	
Ingress protection	IP30 (under proper lens installation and wiring)	
Temperature	Working temperature: 0 °C to 50 °C (32 °F to 122 °F) Storage temperature: -30 °C to 70 °C (-22 °F to 158 °F)	
Humidity	20% to 80% RH, without condensation	
General		
Client software	MVS or third-party software meeting with USB3.0 Vision Protocol	
Operating system	32/64-bit Windows XP/7/10, 32/64-bit Linux	
Compatibility	USB3 Vision, GenICam	
Certification	CE, FCC, RoHS, KC	