

MV-CA050-12UM/UC

5.0 MP 2/3" CMOS USB3.0 Area Scan Camera



GEN*i*CAM

US3TM
VISION

Introduction

MV-CA050-12UM/UC camera adopts Sony® IMX264 sensor to provide high-quality image. It uses USB3.0 interface to transmit non-compressed images in real time, and its max. frame rate can reach 47 fps (mono camera) or 60 fps (color camera) in full resolution.

Key Feature

- Supports auto and manual adjustment for gain, exposure control, white balance, etc.
- Supports hardware trigger, software trigger, free run, etc.
- Adopts M2 screw holes for securing cable that connects USB3.0 interface.
- Compatible with USB3 Vision Protocol, GenCam Standard, and the third-party software based on these protocol and standard.

Dimension

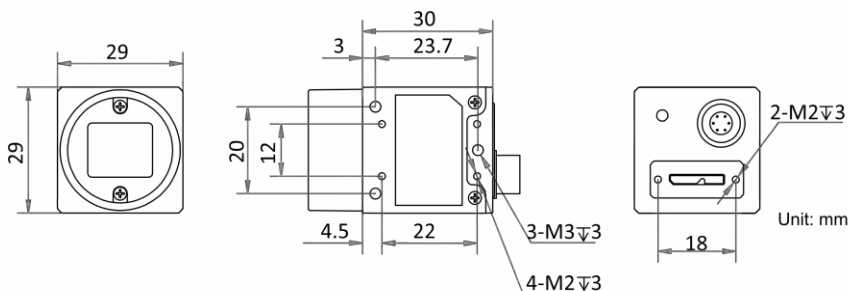

Available Model

- Mono camera: MV-CA050-12UM
- Color camera: MV-CA050-12UC

Applicable Industry

Electronic semiconductor, factory automation, liquor and beverage, medicine packing, etc.

Sensor Quantum Efficiency

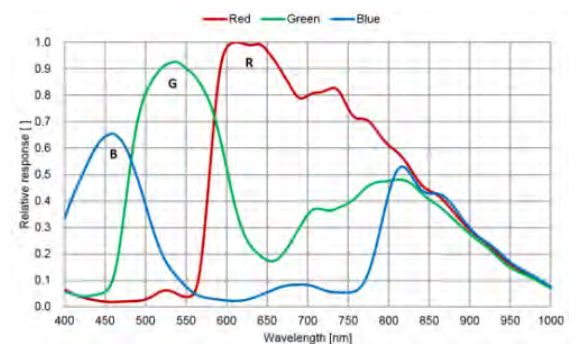

Specification

| Model | MV-CA050-12UM | MV-CA050-12UC |
|---------------------------|--|--|
| Camera | | |
| Sensor type | CMOS, global shutter | |
| Sensor model | Sony® IMX264 | |
| Pixel size | 3.45 μm × 3.45 μm | |
| Sensor size | 2/3" | |
| Resolution | 2448 × 2048 | |
| Max. frame rate | 47 fps @2448 × 2048 | 60 fps @2448 × 2048 |
| Dynamic range | 72 dB | |
| SNR | 40.2 dB | |
| Gain | 0 dB to 24 dB | 0 dB to 20 dB |
| Exposure time | UltraShort exposure mode: 1 μs to 14 μs | |
| | Standard exposure mode: 15 μs to 10 sec | |
| Exposure mode | Off/Once/Continuous exposure mode | |
| Mono/color | Mono | Color |
| Pixel format | Mono 8/10/10p/12/12p | Mono 8/10/12, Bayer RG 8/10/10p/12/12p, YUV422Packed, YUV422_YUYV_Packed, RGB 8, BGR 8 |
| Binning | Supports 1 × 1, 2 × 2, 4 × 4 | |
| Decimation | Supports 1 × 1, 2 × 2 | |
| Reverse image | Supports horizontal and vertical reverse image output | |
| Electrical feature | | |
| Data interface | USB3.0, compatible with USB2.0 | |
| Digital I/O | 6-pin P7 connector provides power and I/O, including opto-isolated input × 1 (Line 0), opto-isolated output × 1 (Line 1), and bi-directional non-isolated I/O × 1 (Line 2) | |
| Power supply | 9 VDC to 24 VDC, supports USB3.0 power supply | |
| Power consumption | Typ. 2.9 W @5 VDC (USB3.0 provides power supply) | Typ. 3.3 W @5 VDC (USB3.0 provides power supply) |
| Mechanical | | |
| Lens mount | C-Mount | |
| Dimension | 29 mm × 29 mm × 30 mm (1.1" × 1.1" × 1.2") | |
| Weight | Approx. 80 g (0.18 lb.) | |
| Ingress protection | IP30 (under correct lens installation and wiring) | |
| Temperature | Working temperature: 0 °C to 50 °C (32 °F to 122 °F) Storage temperature: -30 °C to 70 °C (-22 °F to 158 °F) | |
| Humidity | 20% to 80% RH, non-condensing | |
| General | | |
| Client software | MVS or third-party software meeting with USB3 Vision Protocol | |
| Operating system | 32/64-bit Windows XP/7/10, 32/64-bit Linux and 64-bit MacOS | |
| Compatibility | USB3 Vision, GenICam | |
| Certifications | CE, FCC, RoHS, KC | |

HIKROBOT

Hangzhou Hikrobot Technology Co., Ltd.
No.399 Danfeng Road, Binjiang District, Hangzhou 310051, China.
en.hikrobotics.com

MaxxVision®

Sigmaringer Str. 121
70567 Stuttgart
Tel.: 0711 997 996 3
www.maxxvision.com

Copyright Hikrobot

Hangzhou Hikrobot Technology Co., Ltd. All Rights Reserved. Hangzhou Hikrobot Technology does not tolerate any infringement. Any organization or individual may not imitate or reproduce in whole or in part of the content. The data herein is based on Hikrobot's internal evaluation. Actual data may vary depending on specific configuration and operating condition. The information herein is subject to change without notice. All the content has been checked conscientiously. Nevertheless, Hikrobot shall not be liable to damages resulting from errors, inconsistencies or omissions.